

GARAGES

TYPICAL REQUIREMENTS FOR DETACHED GARAGES

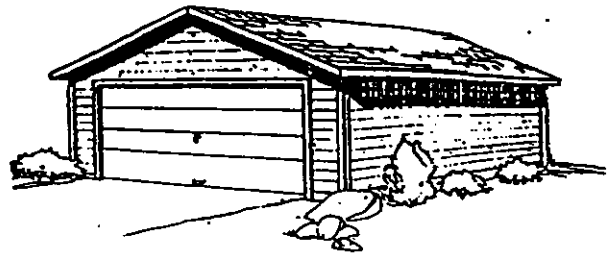

GARAGE DOOR HEADERS (BASED ON 24'-0" ROOF SPAN AND SUPPORTING ROOF TRUSSES)

9'-0" DOORS - DOUBLE 2X10 WITH 1/2" PLYWOOD GLUED & NAILED

16'-0" DOORS - TRIPLE 2X14 OR,
DOUBLE 14" LVL

NOTE: SINGLE STUD BEARING REQUIRED FOR 9'-0" DOORS,
TWO STUD BRG. REQ. FOR 16'-0" & 18'-0" DOORS.

Note If Vinyl Siding is Applied All studs must be 16" O.C. including Gable Truss

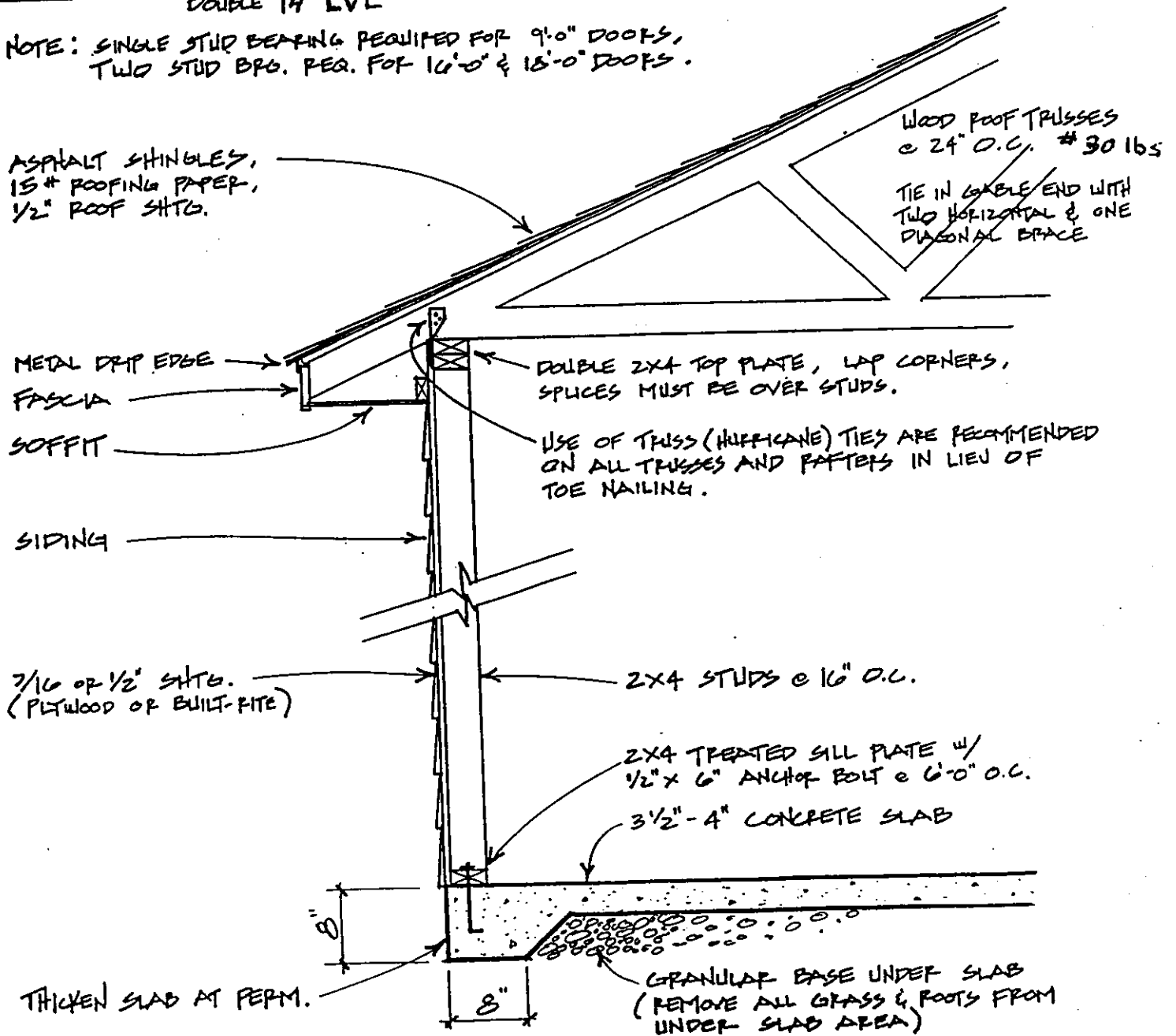

WALL SECTION

ROAD

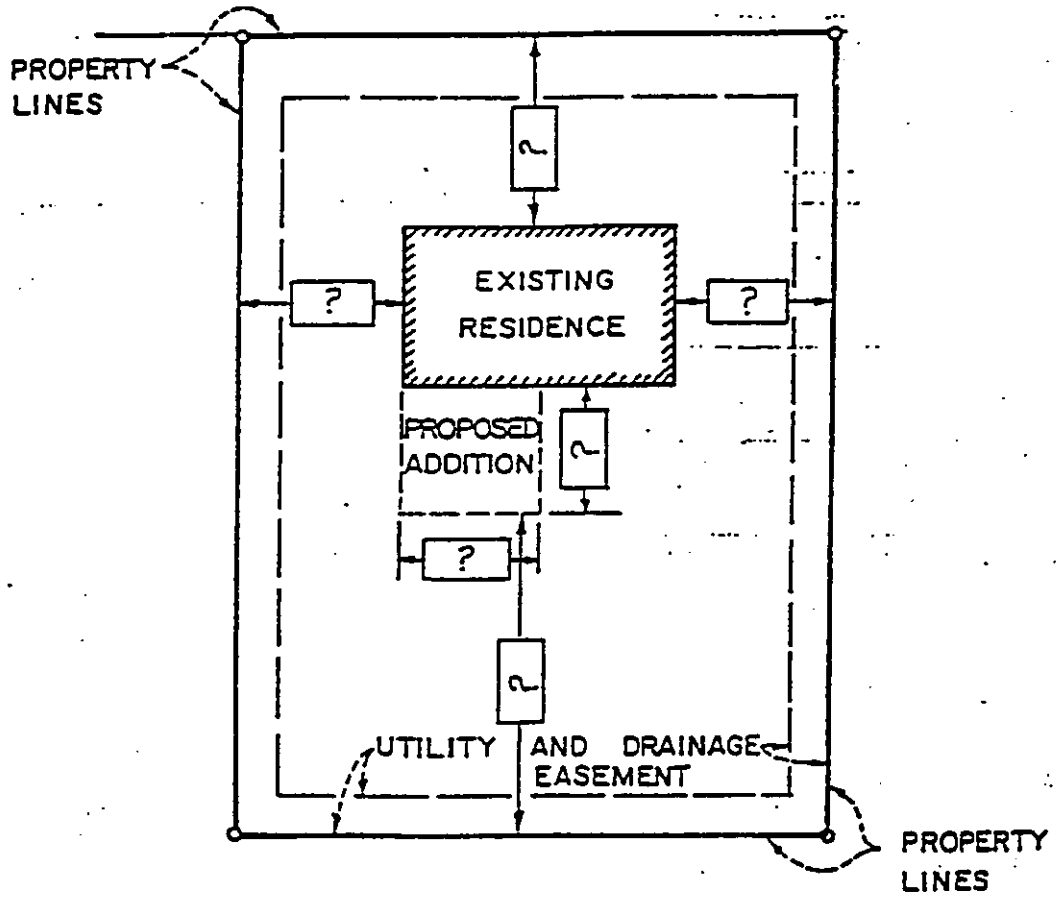

Detached Garage with Frost Footings

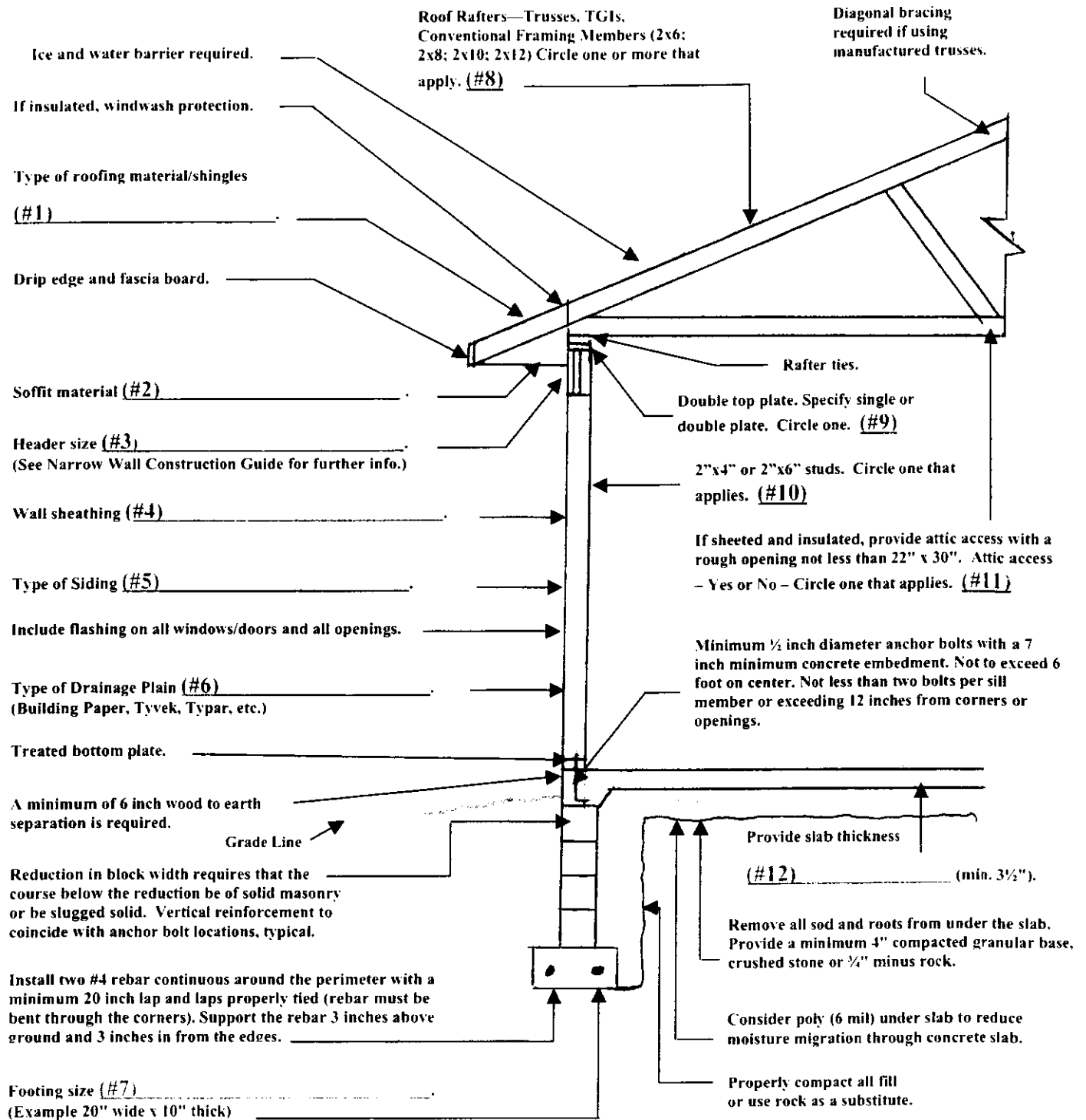

Detached Garage on a Floating Slab

